



ATHLETIC TRAINING ROOM EQUIPMENT



THE ATHLETIC EDGE

2017-2018

FIRST IMPRESSIONS MEAN EVERYTHING.



CUSTOM BRANDING

The Athletic Edge offers unique and cost effective ways to display your team spirit.

Request your mockup today: 800.743.7738



Customization • Extensive product line • Industry-leading product development and solutions

PRODUCT INNOVATION

This is why we have the **EDGE**:

The Athletic Edge goes above standards in terms of product innovation. We offer an extensive product line drawn from our values of durability, user-friendliness, patient comfort and branding ability. Customize each AE product to help tell your story.

Whatever your vision may be,
the Athletic Edge can make it
come to life.



PRO 3 Seat Tilt Taping Station for the Dallas Mavericks
PRO-TTS3 with options

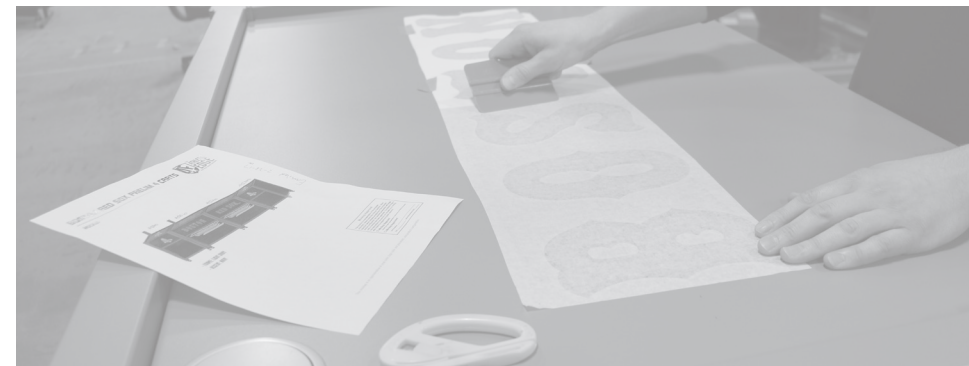

Custom Recovery Cart
for the Boston Red Sox

CUSTOM STAIN

St. Augustine High School already had equipment in their existing facility and needed their Athletic Edge equipment to match. Our expert craftsmen were excited to try new techniques to make St. Augustine's wish a reality. To match the current equipment in St. Augustine's training facility, they chose the wood base option on their treatment tables and taping station and we finished it off with a sharp grey wood stain to accompany the look of our Aluma Elite aluminum products.



TESS with options

Custom stain on Edge Sport Treatment Table to match the powder coat color of Aluma Elite Products for St. Augustine High School



Aluma Elite Treatment Table for
St. Augustine High School
A4201 with options



3 seat custom taping station
for St. Augustine High School
TTS3 with options



PRODUCT INNOVATION

#WEHAVETHEEDGE • TeamEdgeAthletics.com



PRO SERIES

The Athletic Edge PRO Series offers larger sizes of our most innovative equipment for the larger athlete and more storage. Add 6" in width to the 6' SmartCart cushion and more pass-through storage or add 8" inches in length to the PRO Treatment Cabinet.



6' PRO SmartCart for Texas A&M University
A2706-PRO



PRO 3 Seat Tilt Taping Station for the Dallas Mavericks
PRO-TTS3 with options



Custom Walnut PRO Treatment
Cabinet for the Philadelphia 76ers
CAB-PRO with options



Custom Walnut Mobile Deluxe Carts
for the Philadelphia 76ers
SMDC-002 with options



PRODUCT INNOVATION

#WEHAVETHEEDGE • TeamEdgeAthletics.com



THE ALUMA ELITE SERIES

The training room is the focal point for each athletic team's activities. The Aluma Elite product line exemplifies top-of-the-line quality and craftsmanship. Such quality results in a line of aluminum equipment that can withstand everyday use and the harshest environments. Expect more with Aluma Elite taping stations, taping tables, treatment tables, whirlpool tables, modality carts, portable workstations, cabinets and lockers - all the best quality for your investment!





ALUMA ELITE TREATMENT TABLES



A4201 with options

The dependable Aluma Elite Treatment Table is the perfect centerpiece for each athletic training facility. The extraordinary load capacity of 750 lbs. and the standard 2 tape holders and aluminum shelf for storage make the Aluma Elite tables the perfect table for athletic trainers and athletes alike. Choose from multiple top options and adjunct storage options to customize your treatment table to meet your needs.

FEATURES:

- 30"W x 78"D x 31"H
- Load Capacity: 750 lbs.
- Table comes standard with flat top and bottom shelf
- Tape holder on each end of table
- Tough powder coat finish
- Graphics Package: includes (1) school logo/name decal on each tape holder (1 on each end) and (1) decal on the bottom shelf
- Cushion: 2" foam, semi-firm



See our website for additional models

ALUMA ELITE TAPING STATIONS



A4202



See our website for new lift back option

Each modular taping station is crafted with the most dependable aluminum and each taping seat is accompanied by its own tape holders and shelves. The standard center cabinet has three drawers with a lock and a dynamic phenolic top. Multiple height and depth configurations available. Need additional space? Extend your taping stations by adding adjunct cabinets and seats.

FEATURES:

- Taping seats can be ordered in 36" or 42" heights and can accommodate depths of 36", 42" or 48" (All configurations are 84.5" wide)
- Load Capacity: 500 lbs. per seat
- (2) Tape holders and shelves
- Tough powder coat finish
- 28" wide cabinet with 3 drawer lockable storage
- Graphics Package: includes (1) school logo/name decal on each taping seat tape holder and on (1) cabinet drawer
- Waste bin cutout on center cabinet
- Cushions: 2" foam, semi-firm
- High grade phenolic top on cabinet
- Ship as modular units - some assembly required
- Taping stations can be extended by adding additional cabinets and seats

#WEHAVETHEEDGE • TeamEdgeAthletics.com



#WEHAVETHEEDGE

"Athletic Edge has an incredible product. They really came through for us on short notice and delivered exactly what we needed. Our student athletes love the versatility of the tables, the width of them, and how comfortable they are. There is no doubt I would definitely use Athletic Edge again if I were to need new tables!"

Trent Stratton, Assistant Athletic Director for Sports Medicine
Kent State University

ALUMA ELITE TAPING TABLES



A4200

Every sturdy Aluma Elite Taping Table is the perfect addition to each athletic training room for all your taping needs. These aluminum tables come with tape holders and an aluminum shelf for storage purposes.

FEATURES:

- 30"W x 48"D x 36"H
- 30" wide cushion top
- Load Capacity: 500 lbs.
- Tape holder on each end
- Tough powder coat finish
- Graphics Package: includes (1) school logo/name decal on each tape holder (1 on each end)
- Cushion: 2" foam, semi-firm

NEW ALUMA ELITE MAT TABLES



A4495

The Aluma Elite Mat Table is one of the most dependable Aluma Elite products with a load capacity of 800 lbs. to 1,200 lbs. Built with durable aluminum, the Mat Table can handle the harshest environments and withstand any abuse athletic trainers and athletes throw at it.

FEATURES:

- 18"H (Available in 4' x 7', 5' x 7' and 6' x 8' configurations)
- Load Capacity: 4' x 7' - 800 lbs., 5' x 7' & 6' x 8' - 1200 lbs.
- Tape holder on each end
- Welded frames & leveling feet
- Tough powder coat finish
- Graphics Package: includes (1) school logo/name decal on each tape holder (1 on each end)
- 1.5" foam, semi-firm

ALUMA ELITE MODALITY CARTS



NEW  See our website for new configurations

The Aluma Elite Modality Cart brings mobility and versatility to your athletic training storage equipment. Dynamic, durable, yet lightweight, the Modality cart features a key lock and sizable drawers to store all essential athletic training equipment and accessories.

FEATURES:

- 31"W x 23"D x 38"H
- Durable aluminum construction
- Tough powder coat finish
- Drawer key lock
- 5.5" Drawer
- (4) 2" Non-marking casters with brakes
- Electrical grommets for easy cord routing
- Graphics package: includes (1) decal on lower doors

NEW ALUMA ELITE XL RECOVERY CARTS



The XL Recovery Cart features mobility and storage for the NormaTec™ Leg Recovery System. The cart is constructed of durable aluminum and features a slide-out boot rack, two drawers, locking casters, a built in medical grade power strip, pop-up outlets and USB ports. NormaTec™ Recovery System not included.

FEATURES:

- 49"W x 32"D x 43"H
- Durable aluminum construction
- Tough powder coat finish
- 1 slide out boot rack holds 2 pairs of NormaTec boots
- 2 drawers (20.5"W x 17.5"D x 12"H)
- Locking casters
- Built-in medical grade power strip with 6' cord
- Pop-up power with 3 outlets and 2 USB ports
- Graphics package: includes custom graphics on 2 front drawers

ALUMA ELITE LOCKERS



A3500
with options

A3504
with options

The newest line of Athletic Edge lockers, the Aluma Elite locker line, is designed to provide ample storage while showcasing your team pride. Add a padded seat cushion, a full-length door and/or a nameplate to best compliment your locker room.

FEATURES:

- Available in widths of 18", 24" or 30", depths of 18" or 24", and heights of 72" or 78"
- All aluminum lockers may be shipped fully assembled or in a knock-down configuration.
- Aluminum components support and extend the life and durability of the product
- Phenolic seat lid holds up well in tough conditions

NEW ALUMA ELITE PORTABLE WORKSTATION



PW4000

The Aluma Elite Portable Workstation, with patent pending and industry leading mobility features, is Athletic Edge's latest solution for sideline treatment and care. Made from aluminum and complimented with a rugged, textured powder coat finish, this workstation offers an affordable and convenient solution for treating your athletes.

FEATURES:

- Open table: 73" L x 24" W x 32" H
- Load capacity: 750 lbs.
- Workstation weight: 96 lbs.
- Made from aluminum, offering a durable platform that is easy to maneuver
- Patent-pending wheel-locking mechanism with stow-away handle
- Lockable storage cabinet with access from both sides
- Graphics package includes: logo on each side panel (2 total)

ALUMA ELITE WHIRLPOOL TABLES



A4162



A4159

The Aluma Elite Whirlpool Table's sturdy aluminum construction with the durable phenolic top and steps allow the whirlpool table to thrive in harsh, wet environments.

FEATURES:

- Single Whirlpool Table: 46"W x 38.25"D x 31" or 34"H
- Double Whirlpool Table: 80.5"W x 38.25"D x 31" or 34"H
- 31" or 34" standard heights available
- Load Capacity: 600 lbs.
- Durable aluminum construction
- Rugged phenolic top
- Storage shelf
- Tough powder coat finish
- Graphics Package: includes (1) school logo/name decal on each end panel (1 on each end)
- Single or dual tables available



See our website for additional models

#WEHAVETHEEDGE • TeamEdgeAthletics.com

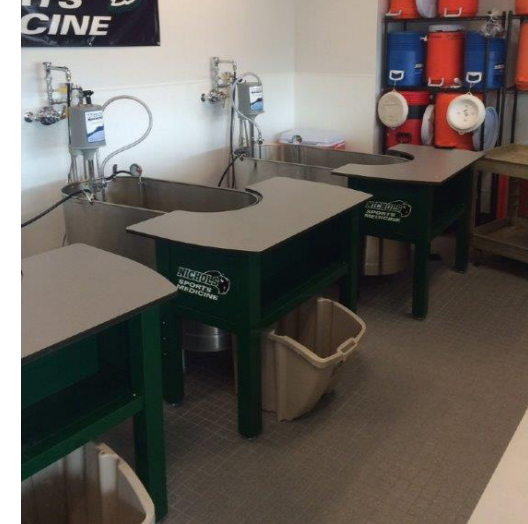

LAST TABLE

LEG & SHOULDER THERAPY TABLES™

The LAST Table™ is ergonomically designed and the first treatment/exercise table that permits bilateral training and specific anatomical positioning necessary to achieve desired results. The distinct Hi-Lo elevating base allows individuals with limited mobility access to the table in any setting.

FEATURES:

- 84" L x 30" W
- Height: 19" - 37"
- Lifting capacity: 400 lbs.
- Adjustable top with standard elevating base
- Elevating back 0 - 70°
- Elevating legs 0 - 90°
- Leg height of 17"
- Drop legs 0 - 90°
- 2" high-density firm foam with rounded corners
- Single foot pedal
- Low profile locking casters
- White base powder coat



PT9060 with options



PT9060 with options



PT9060 with options

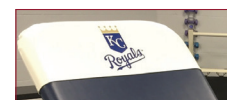

SLIP COVER

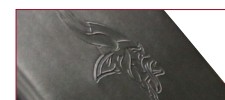

DEBOSSED LOGO



COLOR EDGE PRINT



BASE BRANDING

6 OPTIONAL BRANDING KITS AVAILABLE: include white or custom colored base and cushion/base branding

THERA-P TABLE



Ease of use, multiple options and a sleek but durable design make the THERA-P line of electric treatment tables the choice of therapists everywhere. Six top options allow therapists to choose the table that best meets their needs and that ensures patients' most comfortable positioning. The THERA-P electric treatment table is constructed of precision-cut flat and tube steel for durability and style. It also has a whisper-quiet lift system (with elevating foot switch) and easy-to-operate caster system for better ergonomics.

FEATURES:

- 77" L x 27" W
- Height: 17" - 35"
- Lifting capacity: 400 lbs.
- 2" high-density firm foam with rounded corners
- Single foot pedal
- Low profile locking casters
- White base powder coat
- Whisper Quiet Lift System
- Bariatric version available with 40" wide cushion

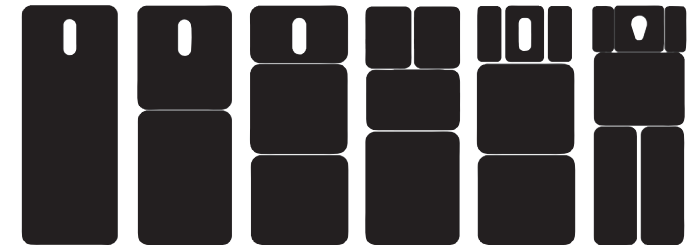

6 TOP CONFIGURATIONS



PT1103 with options



SLIP COVER



DEBOSSED LOGO



COLOR EDGE PRINT



BASE BRANDING

6 OPTIONAL BRANDING KITS AVAILABLE: include white or custom colored base and cushion/base branding



PT1103



PT1103 with options

NEW PT-2000 BARIATRIC HI-LO MAT TABLE



\$2550

The Bariatric Electric Hi-Lo Mat Table is ideal for the rehabilitation setting. It is available in a range of sizes to provide your facility with the option of delivering optimum care for larger patients.

FEATURES:

- Available sizes: 4'W x 7'D, 5'W x 7'D, 6'W x 8'D
- Height range: 18" - 30"H
- Load capacity: 1,000 lbs.
- Hi-Lo Elevation
- Single Foot Control
- Convenient caster system

NEW ME SERIES ELEVATING TABLE



ME-2000

This dynamic table was designed and built with the highest standards of quality, integrity and innovation. With its quiet and smooth elevation, the ME Series Elevating Table eliminates the constant squatting and bending while treating patients, leaving them with more energy at the end of the work day.

FEATURES:

- Height: 24" - 36"
- Length: 77"
- Width: 28"
- Lifting Capacity: 400 lbs.
- Complete cabinet with 4 sliding doors and 1 single mounted foot control
- Flat 2" high density cushion with rounded corners
- Lift back option available

NEW ELECTRIC TREATMENT CABINET



ET-102 with options

The Electric Treatment Cabinet sets the standard in functionality, ease of use, storage and convenience. With an easy-to operate adjustable height ranging from 29" to 44", and the numerous cabinet and top options, this cabinet serves most athletic trainers' needs. This cabinet can be upgraded to include lift back and split leg options on the cushion top, and you can upgrade the cabinet configuration to include storage on one or two sides. Enhance your room by adding one of our custom branding options on the cushion or cabinet.

FEATURES:

- Height: 29" - 44", Length: 83", Width: 30"
- Lifting Capacity: 500 lbs.
- Durable metal cabinet with black powdercoat
- Leveling feet on cabinet base
- Open shelf storage area
- Single mounted hand control
- Quiet and smooth actuators elevate athletes with ease
- Flat 2" high density cushion with rounded corners
- Storage cabinets with doors include locks

#WEHAVETHEEDGE • TeamEdgeAthletics.com





KEEPING WITH TRADITION

The Athletic Edge's laminate and wood tables, taping stations, and cabinets are built by the most experienced craftsmen. Our wood treatment products are perfect for keeping with tradition of the classic wood athletic training equipment. Expect more with the quality and craftsmanship of The Athletic Edge's laminate and wood products!



TAPING STATIONS

Custom Taping Station



The modular, flat-top design of our taping stations deliver comfort, strength and convenience. They feature a 2" high-density foam top, optional wall pads and durable dowel and glue construction. Our taping stations are also fitted throughout with shelves, cabinets and full-extension drawer glides for convenient storage. Choose from laminate and wood base options. Custom branding showcases your school, organization or team logo.

FEATURES:

- Depths (Flat taping stations): 36", 42" or 48"
- Depths (Tilt taping stations): 42" or 48"
- Heights: 36" or 42"
- Load capacity: 450 lbs.
- Laminate and wood options
- Dowel and glue construction
- Full extension drawer glides
- Front and side access
- 3" wire pull handles
- 2" high density cushion
- Fully finished cabinets



See our website for additional models



NEW PRO-TTS1 with options

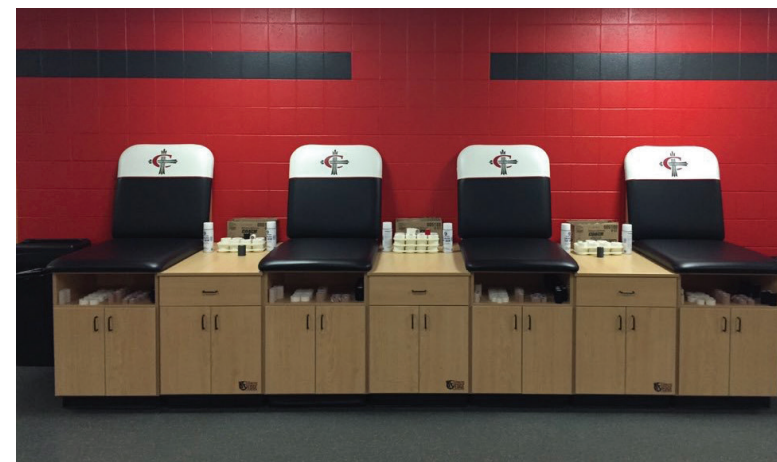

CFCL

Taping stations also available with custom full color laminate

#WEHAVETHEEDGE • TeamEdgeAthletics.com

NEW LEG & SHOULDER TREATMENT CABINET



CAB-100-LST with options

The Leg and Shoulder Treatment Cabinet supports bilateral training and specific anatomical positioning to achieve the desired results for athletes, while the athletic trainers can store athletic training equipment at arm's reach.

FEATURES:

- 30"W x 84"D x 34"H
- Height: 34.25"
- Load Capacity: 500 lbs.
- 2" high-density firm foam with rounded corners
- Manual elevating lift back 0 – 70 degrees
- Elevating Legs 0 – 90 degrees (legs drop out or elevate in split leg fashion)
- Maple or Oak with durable lacquer finish
- 4 doors on each side with fixed pass through shelf

TREATMENT & RECOVERY CABINET



CAB-090N

Athletic trainers will save time by storing the NormaTec™ within arm's reach, which empowers the athletes to control treatment if needed, allowing the athletic trainer to multi-task. The boot rack and vented drawer minimizes setup time, storage, and clutter. NormaTec™ recovery system not included.

FEATURES:

- 30"W x 83"D x 32"H
- Dual extension drawer to fit NormaTec™ product line
- Dual extension boot rack accommodates 2 pairs of NormaTec™ boots
- Trays hold recovery unit on both sides
- Available in laminate or wood (natural finish or black stain)
- 2" high density foam cushion with 57° lift back and split legs
- Graphics package with NormaTec™ and Athletic Edge branding (add your school/organization logo above the pull out drawers for no additional charge)

CAB-010



CAB-010 with options

The CAB-010 model features closed storage for neater presentation.

FEATURES:

- 30"W x 78" D x 31" H
- Load Capacity: 600 lbs.
- Available in laminate or wood
- 3 section cabinet including 6 hinged doors with an adjustable shelf for each cabinet
- 2" high density foam with rounded corners
- Wire pull handles

TREATMENT CABINETS



CAB-050



CAB-050 with options

The CAB-050 model is a 2-section cabinet with sliding doors, ideal for storing larger items.

FEATURES:

- 30"W x 78" D x 31" H
- Load Capacity: 600 lbs.
- 2" high density foam
- Available in laminate or wood
- 2 Section Cabinet with adjustable shelf in each section
- Sliding doors



See our website for additional models

CAB-070



CAB-070 with options

The CAB-070 model is a 3-section cabinet with 4 hinged doors and open storage on each side.

FEATURES:

- 30"W x 78" D x 31" H
- Load Capacity: 600 lbs.
- Available in laminate or wood
- 3 section cabinet with open storage under split leg section
- 2" high density foam with rounded corners
- Wire pull handles

NEW CAB-PRO



CAB-PRO with options

The CAB-PRO Treatment Cabinet features a larger cushion measuring 32" W x 86" D, four hinged doors on each side of the cabinet, an adjustable shelf in each cabinet, and pass through storage. Apply your team or organization logo to the cushion top and to the cabinet exterior.

FEATURES:

- 32"W x 86" D x 31" H
- Load Capacity: 600 lbs.
- Available in laminate or wood
- 3 section cabinet including 4 hinged doors with an adjustable shelf for each cabinet and pass through storage (4 doors on each side)
- Flat, seamless cushion made of 2" high density foam with rounded corners
- Wire pull handles



EDGE SPORT WOOD TREATMENT TABLES



TESS with options



FESS-6L

Each table comes standard with solid hardwood legs and base, H-brace construction, a thick 3/4" plywood top, comfortable 2" foam padding, softly rounded corners and dual-bolted leg assembly that folds down for easy shipping. Make it your own by adding length or width, shelves or a cabinet. Patient-friendly customizations include a nose hole and lift back featuring 70° of tilt and 6-position manual elevation.

4 LEG EDGE SPORT FEATURES:

- 31"H
- Load Capacity: 550 lbs.
- Choose from:
 - 27" or 30" W
 - 72" or 78" D
 - Flat top or lift back
 - 3 shelf/cabinet options
 - Optional nose hole

6 LEG EDGE SPORT FEATURES:

- 31"H
- Load Capacity: 650 lbs.
- Standard shelf
- Choose from:
 - Flat top, lift back and/or split leg option
 - 2 shelf/cabinet options
 - Optional nose hole



See our website for additional models

#WEHAVETHEEDGE • TeamEdgeAthletics.com

NEW COMBINATION LAB TABLE/ DESK



FESS-LAB

The Combination Lab Table/Desk is a desk or treatment table ideal for classroom training. The table is constructed of solid hardwood with a flat, laminate top. The table can be built using oak or maple wood. Choose from three standard colors for the laminate top. Some on site assembly required.

FEATURES:

- 27"W x 72"D x 30"H
- Load Capacity: 450 lbs.
- 4 leg, solid hardwood construction
- Flat, laminate top
- 24" clearance for stools



Custom laminate colors and custom printed laminate available on orders of 10 or more tables.

NEW CLASSROOM/LAB TREATMENT TABLE



FESS-LAB-6L with options

The Classroom/Lab Treatment Table is a multi-purpose desk and treatment table perfect for a clinic or classroom setting. The table is constructed of solid hardwood with a flat, laminate top. The table can be built using oak or maple wood. Add storage to your table by adding 2 open cubbies. An optional removable 2" vinyl/foam pad attaches to the laminate table top using hook and loop fastener. Some on site assembly required.

FEATURES:

- 27"W x 78"D x 32"H
- Load Capacity: 600 lbs.
- 6 leg, solid hardwood construction
- Flat, laminate top
- 24" clearance for stools

NEW WALL MOUNT FOLDING TREATMENT TABLE



WMFTT

The Wall Mount Folding Treatment Table is a fold out treatment table ideal for small spaces. The table is constructed of solid hardwood with a flat, seamless 2" high density foam cushion. Three legs attach to the wall, while the two front legs and cushion fold out away from the wall when needed. A durable wall mounting plate is included (wall fasteners not included). Choose your upholstery color from our 12 standard colors.

FEATURES:

- 24"W x 72"D x 31"H
- Load Capacity: 450 lbs.
- Solid hardwood construction
- Flat, seamless 2" high density foam cushion
- Durable wall mounting plate

EDGE SPORT WOOD MAT TABLES



Solid hardwood construction means our 4-leg and 6-leg Wood Mat Platform Tables are built for strength and stability during practitioner-assisted rehab, exercise and other treatments. Our mat platform comes standard with solid oak or maple hardwood on the base frame, legs and supports; thick plywood top construction; a layer of comfortable 1.5" high-density foam; softly rounded corners; and triple-bolted leg assembly for extra durability. Customizations include added length and/or width.

FEATURES:

- 4-leg Mat Table available in: 4' x 6', 4' x 7' and 5' x 7'
- 6-leg Mat Table available in: 4' x 7', 5' x 7' and 6' x 8'
- Height: 19"
- 1.5" high density foam with rounded corners
- 3 Mat Platform Sizes
- 2 Wood Options
- 12 Upholstery Colors



See our website for additional models

WALL MOUNTED MAT TABLE



WMMT-4884

Our wall mounted mat table comes standard with solid oak or maple hardwood on the base frame, legs and supports; thick plywood top construction; a layer of comfortable 1.5" high-density foam; softly rounded corners; and triple-bolted leg assembly for extra durability.

FEATURES:

- Available in 2 sizes: 4' x 7' x 19" H or 5' x 7' x 19" H
- Load capacity: 450 lbs.
- Fold away legs (3 legs in the front & a platform in the back)
- Solid oak or maple hardwood design on base frame, legs and supports
- Depth when folded: 10"

STOR-EDGE MOBILE TREATMENT CARTS



The mobility and size of our Stor-Edge Mobile Treatment Carts makes it easy for trainers and therapists to bring instruments, supplies and even a writing surface right to each athlete during treatment. They are designed for training room use.

FEATURES:

- 2" swivel nylon casters
- Full extension glides
- Shipped fully assembled
- Wood or laminate



SMC-001 FEATURES:

- 24"W x 18"D x 33"H
- (1) 5.5" Drawer
- Adjustable shelf



SMC-002 FEATURES:

- 24"W x 18"D x 33"H
- (1) 5.5" Drawer
- (2) hinged doors with adjustable shelf



SMC-003 FEATURES:

- 18"W x 18"D x 30"H
- (1) 5.5" Drawer
- (1) hinged door



SMC-004 FEATURES:

- 18"W x 18"D x 30"H
- (2) 5.5" Drawers
- (1) 8" Drawer



SMC-005 FEATURES:

- 18"W x 18"D x 30"H
- (1) 5.5" Drop down
- Open storage



SMC-006 FEATURES:

- 18"W x 18"D x 30"H
- (1) 5.5" Drawer
- Open storage



SMDC-001 FEATURES:

- 24"W x 18"D x 38"H
- (2) 5.5" Drawers
- Adjustable shelf



SMDC-002 FEATURES:

- 24"W x 18"D x 38"H
- (2) 5.5" Drawers
- (2) hinged doors with adjustable shelf



SMDC-003 FEATURES:

- 24"W x 18"D x 38"H
- (5) 5.5" Drawers



SMDC-005 FEATURES:

- 19"W x 23"D x 38"H
- (1) 4" Drawer
- Large pull out with (3) storage racks
- **SMDC-006** available with (4) racks (24"W x 23"D x 38"H)



SMDC-007 FEATURES:

- 15"W x 20"D x 32.5"H
- (3) 7.5" Drawers



See our website
for additional
information

MULTI-PURPOSE STOR-EDGE CARTS

Our custom-built (and fully custom branded) Multi-Purpose Stor-edge Carts keep weights, resistance bands and other tools and equipment at arm's reach. Carts are available in multiple configurations and are made in the U.S.A. Each cart can be crafted of solid wood or laminate.



NEW

SR-009
with options

SR-009 FEATURES:

- 36"W x 36"D x 73"H
- Double doors with (2) adjustable shelves for added storage
- 2 drawers
- 3 mm wood edge banding on all exposed edges
- Dumbbell racks and slatwall hooks included where applicable
- 4" heavy duty casters



SR-001 FEATURES:

- 30"W x 18"D x 72"H
- Full view mirror
- Slatwall hanger board for optional accessories
- Dumbbell storage on left and right sides of cart
- Dumbbell racks and slatwall hooks included where applicable
- Band dispensers
- 4" heavy duty casters



SR-008 FEATURES:

- 46"W x 26"D x 43"H
- (5) 18" wide drawers provide adequate storage
- (1) 18" wide upright door with lock for larger storage
- 4" heavy duty casters



SR-002 FEATURES:

- 30"W x 24"D x 61"H
- Multi-purpose storage cart with (2) doors and self-closing Euro-hinges
- Cabinet contains (3) adjustable shelves
- Slatwall hanger board for optional accessories on back of cart
- 4" heavy duty casters



SR-003 FEATURES:

- 30"W x 18"D x 60"H
- Full view mirror
- Slatwall hanger board for optional accessories
- Dumbbell storage on left and right sides of cart
- Dumbbell racks and slatwall hooks included where applicable
- 4" heavy duty casters
- Band dispensers



SR-004 FEATURES:

- 24"W x 24"D x 61"H
- Multiple band dispensers
- Rotating rack allows easy accessibility to supplies
- Dumbbell racks and slatwall hooks included where applicable
- 4" heavy duty casters



SR-005 FEATURES:

- 32"W x 32"D x 72"H
- Slatwall hanger board for optional accessories
- Built in dispensers for bands and tubing
- Drop down table top with key-lock
- (3) drawers for additional storage
- 4" heavy duty casters



SR-006 FEATURES:

- 36"W x 36"D x 73"H
- Double doors with (2) adjustable shelves for added storage
- 2 drawers with flush mount handles
- Only available in wood
- 3 mm wood edge banding on all exposed edges
- Dumbbell racks and slatwall hooks included where applicable
- 4" heavy duty casters



See our website
for additional
information

Multi-purpose carts are sold without components.

CABINETS AND MODULAR SYSTEMS



SC-003



SC-008

Our Stor-Edge line of durable, high-quality cabinets come in wood or laminate finishes. With many options and sizes to choose from, these cabinets can be bought individually, yet grouped for expanded room or wall storage. Durable slatwall material is used on most cabinet backs to provide additional storage options.

FEATURES:

- Full extension glides
- Wood and laminate finishes available
- Locking double door
- Weight racks and slatwall hooks provided

#WEHAVETHEEDGE

"We purchased some tables, taping stations, and cabinetry through The Athletic Edge. Couldn't be happier with the products and quality!"

Tony Taylor, Athletic Trainer
University of Nebraska-Omaha



See our website for additional configurations and options

#WEHAVETHEEDGE • TeamEdgeAthletics.com

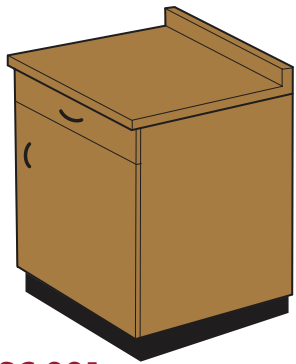

**SC-001
FEATURES:**

- 18"W x 18"D x 30"H
- (1) 5.5" Drawer
- (1) Door

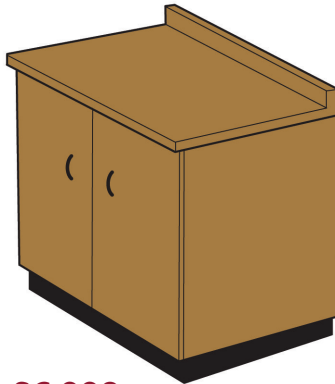

**SC-002
FEATURES:**

- 30"W x 16"D x 30"H
- (2) Doors



**SC-003
FEATURES:**

- 32"W x 23"D x 78"H
- (3) 8" Drawers
- (3) Adjustable Shelves
- Slatwall hanger board
- (2) Doors *(optional)*



**SC-004
FEATURES:**

- 32"W x 23"D x 78"H
- (5) Adjustable Shelves
- (2) Doors *(optional)*



**SC-006
FEATURES:**

- 32"W x 23"D x 78"H
- (4) Drawers
- (6) Adjustable Shelves
- (2) Doors *(optional)*



**SC-007
FEATURES:**

- Single Cubby
15"W x 18"D x 15"H
- Overall
48"W x 18"D x 84"H
- 15 Cubby Storage Cabinet

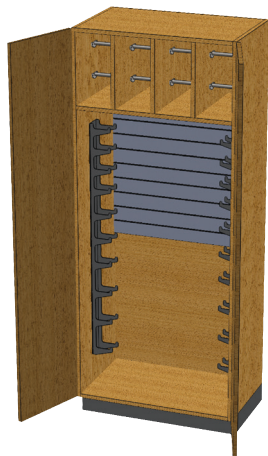

**SC-008
FEATURES:**

- 32"W x 23"D x 78"H
- Band dispensers
- Dumbbell racks
- Slatwall hanger board
- (2) Doors *(optional)*

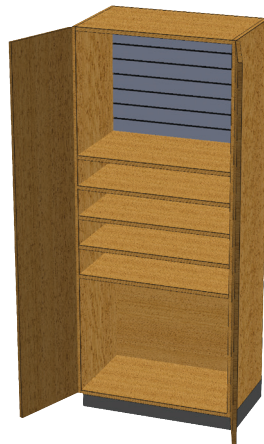

**SC-009
FEATURES:**

- 32"W x 23"D x 78"H
- (5) Adjustable shelves
- Slatwall hanger board
- (2) Doors *(optional)*



**SC-010
FEATURES:**

- 32"W x 23"D x 78"H
- Large storage compartment
- Slatwall hanger board
- (2) Doors *(optional)*



**SC-011
FEATURES:**

- 32"W x 23"D x 78"H
- (1) Adjustable shelf and clothes rod
- (2) Drawers
- Slatwall hanger board
- (2) Doors *(optional)*



**SC-012
FEATURES:**

- 32"W x 23"D x 78"H
- (3) Adjustable shelves
- (6) Storage cubbies
- (2) Doors *(optional)*



**SC-013
FEATURES:**

- 32"W x 23"D x 78"H
- (2) Adjustable shelves and clothes rod
- Slatwall hanger board
- (2) Doors *(optional)*



STOR-EDGE™ MEDICAL CABINETS



SEMCW-007



SEMCB-004-2D

Modular, functional, durable and aesthetically pleasing, our line of Stor-Edge Medical Wall Cabinets is cost-effective and suited for multiple applications. They're also designed for use with our Base Cabinets. Apply custom branding for a finishing touch.

With 20 standard options in our Stor-Edge Medical Base Cabinet line, the choices are almost endless. Choose to apply custom branding to carry your brand story throughout your treatment area, or ask about custom-built options by our cabinet shop.

FEATURES:

- Base cabinets are 36" H, Standard depth: 18" (also available 24" D)
- Wall cabinets are 24" H, Standard depth: 12" (also available 30" D)
- Countertop included (all countertops have 1/2" overhang)
- Must specify left (L) or right (R) hinge on single door cabinets
- Cost effective, yet durable for multiple applications
- Available in wood or laminate choices
- Full extension drawer glides on all drawers
- All cabinets come standard with (1) adjustable shelf



SEMCB-008

MEDICAL WALL CABINETS:

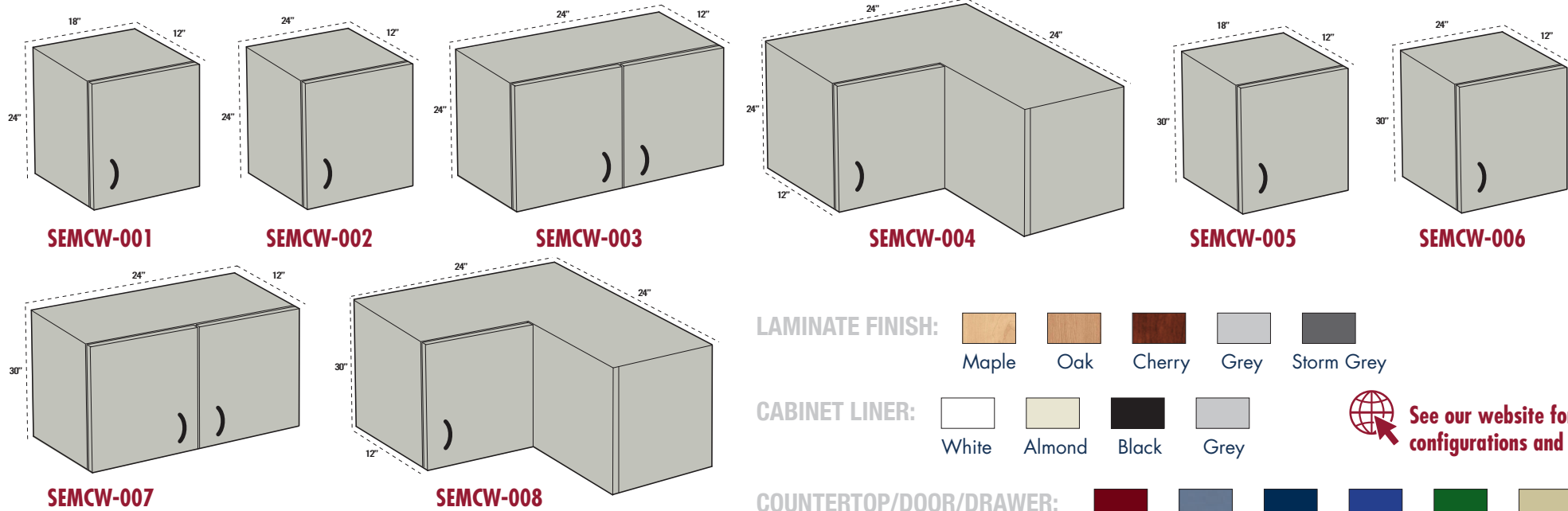

MEDICAL BASE CABINETS:

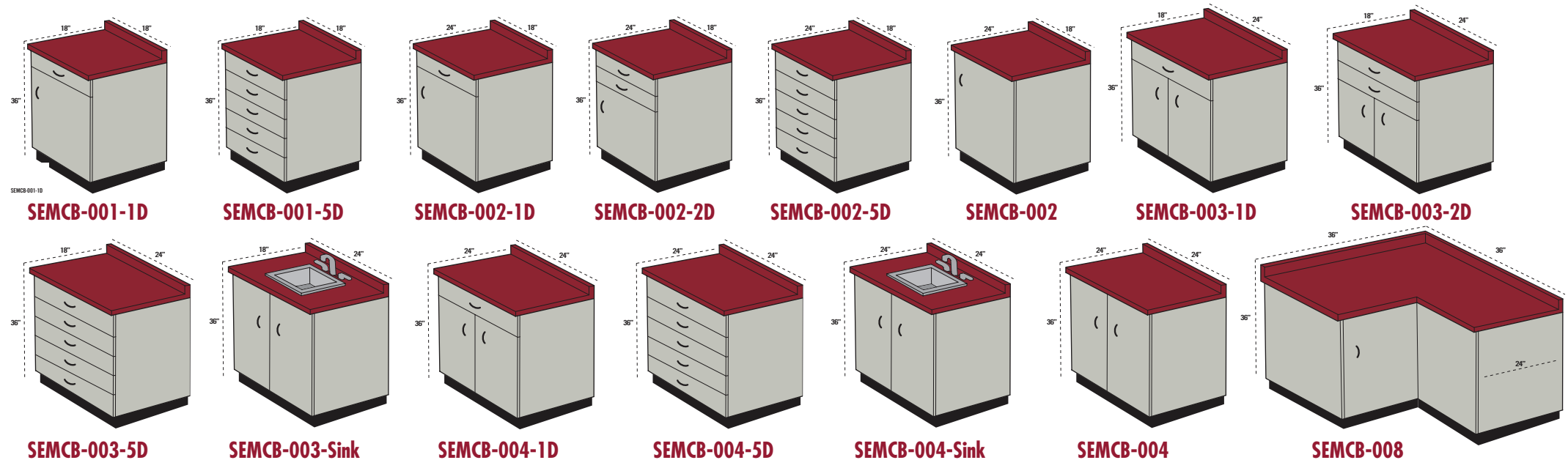



I9390AE

THE SPORT PORTABLE ALUMINUM MASSAGE TABLE

FEATURES:

- 30"W x 73"D
- Height Range: 24" - 33"
- Table Weight: 37 lbs.
- Load Capacity: 600 lbs.
- Removable Field Feet
- Black Carry Case
- Face Rest and Pillow
- 2" Firm Foam

#WEHAVETHEEDGE

"The Sport by Athletic Edge worked amazingly for Queens Sports Medicine as we battled for another National Championship at NCAA."

Brandon Johnson
Director of Sports Medicine | Queens University of Charlotte

SIDELINE SOLUTIONS

The Athletic Edge's sideline solutions allow the athletic training room to come to the field, court or track. Each durable and functional portable table supports sideline treatment and care allowing for immediate treatment to every athlete.



A2200 with options

The all-weather, athletic evaluation **Portable Sideline Table** features a Shiatsu (flat) Cable-Lock™ system.

NEW ALUMA ELITE PORTABLE WORKSTATION



PW4000

The Aluma Elite Portable Workstation, with patent pending and industry leading mobility features, is Athletic Edge's latest solution for sideline treatment and care. Made from aluminum, and complimented with a rugged, textured powder coat finish, this workstation offers an affordable and convenient solution for treating your athletes.

FEATURES:

- Open Table: 73" L x 24" W x 32" H
- Workstation weight: 96 lbs.
- Load capacity: 750 lbs.
- Made from aluminum, offering a durable platform that is easy to maneuver
- Patent-pending wheel-locking mechanism with stow-away handle
- Lockable storage cabinet with access from both sides
- Graphics package includes: logo on each side panel (2 total)

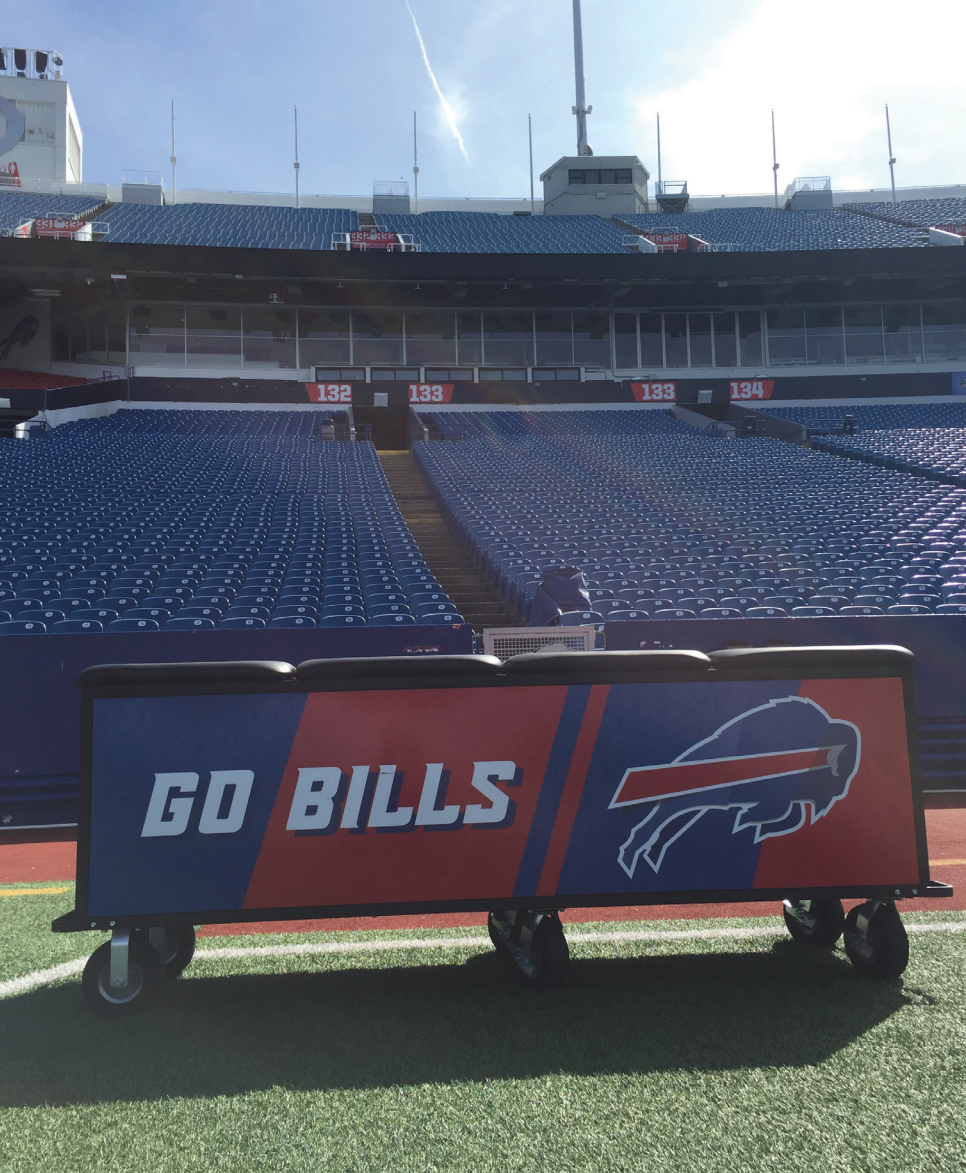

#WEHAVETHEEDGE

"The SmartCart has been invaluable to us. By helping us improve our storage and organization, it's been incredibly helpful in managing injuries on the sideline. It is a wonderful addition to our sports medicine department."

Shone D. Gipson, MS, ATC, LAT, PES, CES
Buffalo Bills | Head Certified Athletic Trainer

SMARTCARTS



A2706

The SmartCart™ is durable, functional and convenient. With its heavy-duty 1.25" tube steel frame, 14 gauge panel steel construction and ample storage, this product is sure to meet all your mobile taping, evaluation and/or treatment needs.

FEATURES:

- Load Capacity: 4', 6' and 6' PRO - 800 lbs.
8' and 8' Hydration - 1,000 lbs.
- Standard lift back
- Durable, rugged construction
- Tough powder coat finish
- Removable shelf
- 3 drawer cabinet
- Pass-through storage compartment
- Pull handle, hitch, locking doors
- Graphics Package: includes cabinet graphics



#WEHAVETHEEDGE • TeamEdgeAthletics.com



Our SmartCart received the Gold Medal in *Training & Conditioning's* "Excellence in Innovation" Award



4' SMARTCART

50"L x 26"W x 36"H

A2704



8' SMARTCART

97"L x 26"W x 36"H

A2708



6' SMARTCART

73"L x 26"W x 36"H



A2706



A2706-PRO

NEW

6' PRO SMARTCART

73"L x 32"W x 36"H

8' HYDRATION SMARTCART

97"L x 26"W x 36"H



A2709



E9011-B

DOC Decompression Table

115 V Targeting of Axial Rotation and Lateral Flexion

- Load Capacity: 350 lbs.
- Axial Rotation and Lateral Flexion Positioning
- Cervical capture headpiece
- Reference library - with patient setup and training materials
- User-defined treatment hold and relax times
- Real-time digital treatment tracking
- Pre-programmed lumbar and cervical decompression protocols
- Digital Command Center

#WEHAVETHEEDGE

"Spinal Decompression is a key component in our treatment/rehabilitative regimen of both lumbar spine and cervical spine pathologies. The DOC table has become one of our greatest advantages for our clinicians to routinely utilize in a successfully return to sport strategy."

Owen Stanley M.S., ATC, CSCS, NREMT
Head FB Athletic Trainer | Texas A&M University

BEYOND THE BASICS



AP2-DT-5000-C

Apollo Desktop Laser Unit

2 Channel Desktop with choice of 500mW, or 3, 4 or 5,000mW probe 9" x 11.25" x 4.5"

- Heavy-duty construction for office and clinic environments
- Probe holders on both sides of the unit that can accommodate two probes and both right and left handed practitioners
- Elevated face for easy viewing and control
- 2 timers allow you to treat 2 patients at the same time



V1000

Whole Body Vibration

- Load Capacity: 308 lbs.
- Medium-intensity vibration training
- A backlit LCM console display with clearly visible workout status
- Non-slip handlebar allows easy use and training from various angles
- 4 training programs: Total Body, Upper Body, Lower Body, Abdominal
- Workout display: Posture Exercise Program, Exercise Time, Frequency, Exercise Group



FMST Tools

FMST Tools

F1 & F2 tools, Foam-lined protective case, Biotene Controlled Glide Massage Creme sample and a 26 page Clinical Guide Book

- FMST Tools are the soft tissue mobilization tools that can take myo-fascial manipulation and mobilization to the next level in your practice.
- The design of the (2) tools available enables you, the practitioner, to work over all surfaces of the body quickly and easily.



See our website for additional details and options

ROLLING STOOLS

NEW CLINICAL STOOL



RS



RS-Logo



PT4008

Our rolling stools combine comfort with control thanks to a 4" deluxe seat cushion, a five-star base with heavy-duty casters and pneumatic controls that adjust seat height from 16" to 22". Give your stool an EDGE with custom branding.

FEATURES:

- 16"W x 16"D x 16-22"H
- Load Capacity: 300 lbs.
- Padded vinyl seat
- 4" deluxe foam cushion
- Heavy duty casters
- Swivel stool
- Choice of 12 standard upholstery colors



LOGO



DEBOSS



COLOR EDGE PRINT

The clinical stool offers comfort, durability and mobility for long periods of sitting and treating athletes. The sleek metal base and black upholstery allow it to fit into any setting, no matter your facility color scheme.

FEATURES:

- 22"W x 22"D x 20.5-25"H
- Pneumatic Lift
- Stainless steel covered casters with high quality upholstery



BENCHES, METAL STOOLS AND WOOD STOOLS
also available.

See our website:

BEYOND THE BASICS

#WEHAVETHEEDGE • TeamEdgeAthletics.com



LOGO RUG

LOGO RUGS

Athletic Edge's Logo Rugs add the perfect finishing touch to any indoor facility. The rug is constructed with static dissipative 100% nylon carpet bonded to 100% premium rubber for superior grease and oil resistance for years of worry-free service.

FEATURES:

- Indoor applications only
- Permanently printed, plush nylon surface
- 100% Nitrile rubber backing for slip/skid resistance
- Fully launderable
- Choose from 150 colors (up to 25 colors per rug)



CEBL-1001



B2

OMNI Cervical Relief Pillow™



The OMNI Cervical Relief Pillow™ uses an ergonomically contoured shape to comfortably "cradle" the head and neck, allowing total relaxation of neck, shoulder and back muscles. Improper cervical curvature is one of the leading causes of headaches. Use the OMNI pillow for minutes a day to help restore proper cervical curvature and release you from neck pain and headaches.

- Relaxes neck, shoulder and back tension
- Helps restore natural cervical curvature
- Comfortable and effective tractioning device
- Great for relaxation, relief from tension headaches and neck pain



K2

The Original Knobble II®

Made of durable polymer with a band of non-latex and Santoprene, The Knobble II gives your hand more power when you need it.

Backnobber II® by Pressure Positive

The Original Backnobber II® is our best-selling deep-muscle massage tool, ideal for self-care. Or, for use with professional medical management and therapy for physical and occupational stress, injuries or chronic conditions such as arthritis or bursitis.



CUSTOM POWDER COAT COLORS

Available for all Aluma Elite products,
Last Table and Thera-P Table branding
kits, and SmartCarts.



STANDARD UPHOLSTERY COLORS

Available for all training
room equipment.



STANDARD WOOD/ LAMINATE CHOICES

Available on taping stations, cabinets
and modality carts.



CUSTOM CUSHION BRANDING

LOGO SLIP COVER

(LOGO COVER) Personalize any treatment table, treatment cabinet, or taping station with your school/organization logo. The logo slip cover is a cost effective, removable cover that slips over the lift back/tilt cushion of your table, cabinet, or taping station. Logo slip covers are also easy to replace if your school or organization update logos or colors.



DEBOSSED LOGO

(LOGO DB) A debossed logo is available on flat or lift back treatment tables, treatment cabinets, and taping stations. During the debossing process, a metal die is pressed down into the upholstery of the cushion leaving an impression of your logo. The debossed logo is a popular branding option that creates a classic look in any space. There is a one time fee for the metal die used to deboss the logo, which can be used on future Athletic Edge equipment orders.



COLOR EDGE PRINT LOGO

(LOGO CP) The Color Edge Print is the newest Athletic Edge cushion branding option. The Color Edge Print logo is printed directly onto your upholstered cushion, and there are no limits on the number of colors printed in your logo. Add color and team spirit to your space by adding a Color Edge Print logo to your treatment table, treatment cabinet, or taping station.



DO YOU HAVE THE EDGE?

You've seen it for yourself- from the get-go, The Athletic Edge works with each customer from start to finish to ensure every specific need is met. We want your products to not only look great, but to tell your story. From the initial facility mockup to the final installation, The Athletic Edge will continue to provide high-quality, successfully branded and beautifully functional equipment and facilities.

Bring THE EDGE to your facility with The Athletic Edge.

REQUEST YOUR CUSTOM MOCKUP TODAY:

800-743-7738 • TeamEdgeAthletics.com

[f /PHSAthleticEdge](https://www.facebook.com/PHSAthleticEdge)

[t /PHSAthleticEdge](https://www.tumblr.com/PHSAthleticEdge)

#WEHAVETHEEDGE • TeamEdgeAthletics.com



#WEHAVETHEEDGE

JOIN THE THOUSANDS OF PROFESSIONAL, COLLEGIATE AND HIGH SCHOOL TEAMS
ACROSS THE COUNTRY THAT HAVE UTILIZED OUR BOLD DESIGN EXPERTISE AND COST-EFFECTIVE SOLUTIONS TO COMMUNICATE
A POSITIVE BRAND IMAGE TO ATHLETES, STUDENTS, BOOSTERS AND THE GENERAL PUBLIC.

724 Oakwood Road • Watertown, SD 57201 • www.TeamEdgeAthletics.com • 800-743-7738

[f /PHSAthleticEdge](https://www.facebook.com/PHSAthleticEdge)

[t /PHSAthleticEdge](https://www.tumblr.com/PHSAthleticEdge)